

KS 2640 MT 3~ 234 Technical specification

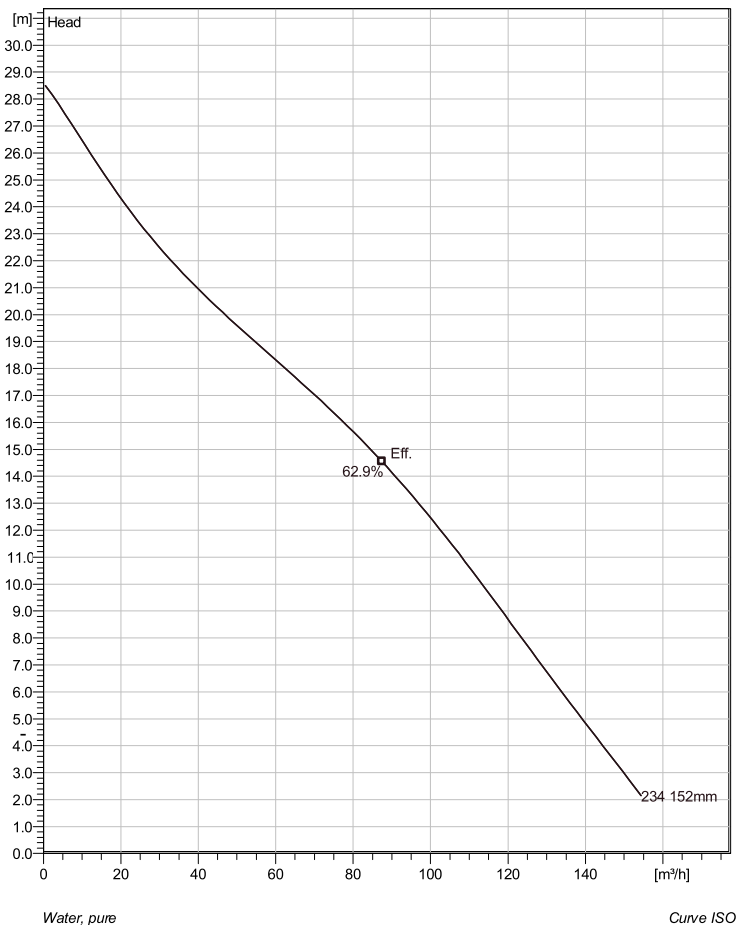

Note: Picture might not correspond to the current configuration.

General

Portable pumps ideal for applications in which the water or liquid contains concentrations of abrasives when clogging problems can occur

Impeller

Impeller material	Hard-Iron
Discharge Flange Diameter	100 mm
Suction Flange Diameter	100 mm
Impeller diameter	152 mm
Number of blades	2

Motor

Motor #	K2640.181 15-14-2BB-W 5.6KW Standard
Stator variant	1
Frequency	50 Hz
Rated voltage	400 V
Number of poles	2
Phases	3~
Rated power	5.6 kW
Rated current	11 A
Starting current	78 A
Rated speed	2895 rpm
Power factor	
1/1 Load	0.87
3/4 Load	0.81
1/2 Load	0.69
Motor efficiency	
1/1 Load	84.2 %
3/4 Load	85.1 %
1/2 Load	84.1 %

Configuration

Installation: S - Portable Semi permanent, Wet

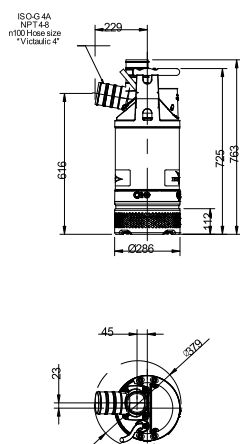

* Designed for "Victaulic Coupling, according to ANSI/AWWA C900-97"

SCREEN OPENING n 10

BS KS 2640.181 MT,HT

Weight (kg)
Pump
50

Project	Project ID	Created by	Created on 9/21/2018	Last update
---------	------------	------------	-------------------------	-------------

KS 2640 MT 3~ 234

Performance curve

Pump

Discharge Flange Diameter	100 mm
Suction Flange Diameter	100 mm
Impeller diameter	152 mm
Number of blades	2

Motor

Motor #	K2640.181 15-14-2BB-W 5.6KW
Stator variant	1
Frequency	50 Hz
Rated voltage	400 V
Number of poles	2
Phases	3~
Rated power	5.6 kW
Rated current	11 A
Starting current	78 A
Rated speed	2895 rpm

Power factor	
1/1 Load	0.87
3/4 Load	0.81
1/2 Load	0.69
Motor efficiency	
1/1 Load	84.2 %
3/4 Load	85.1 %
1/2 Load	84.1 %

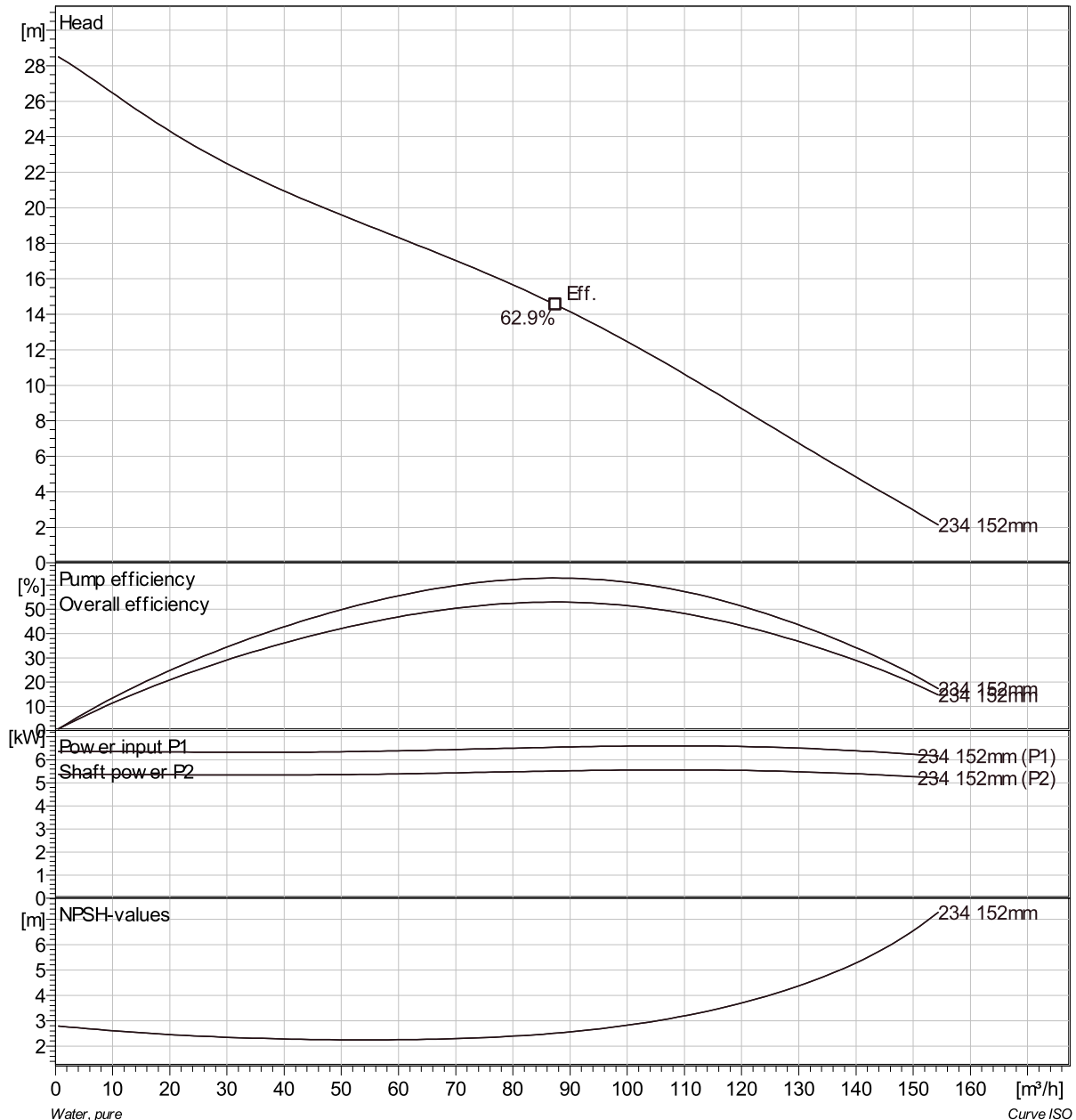

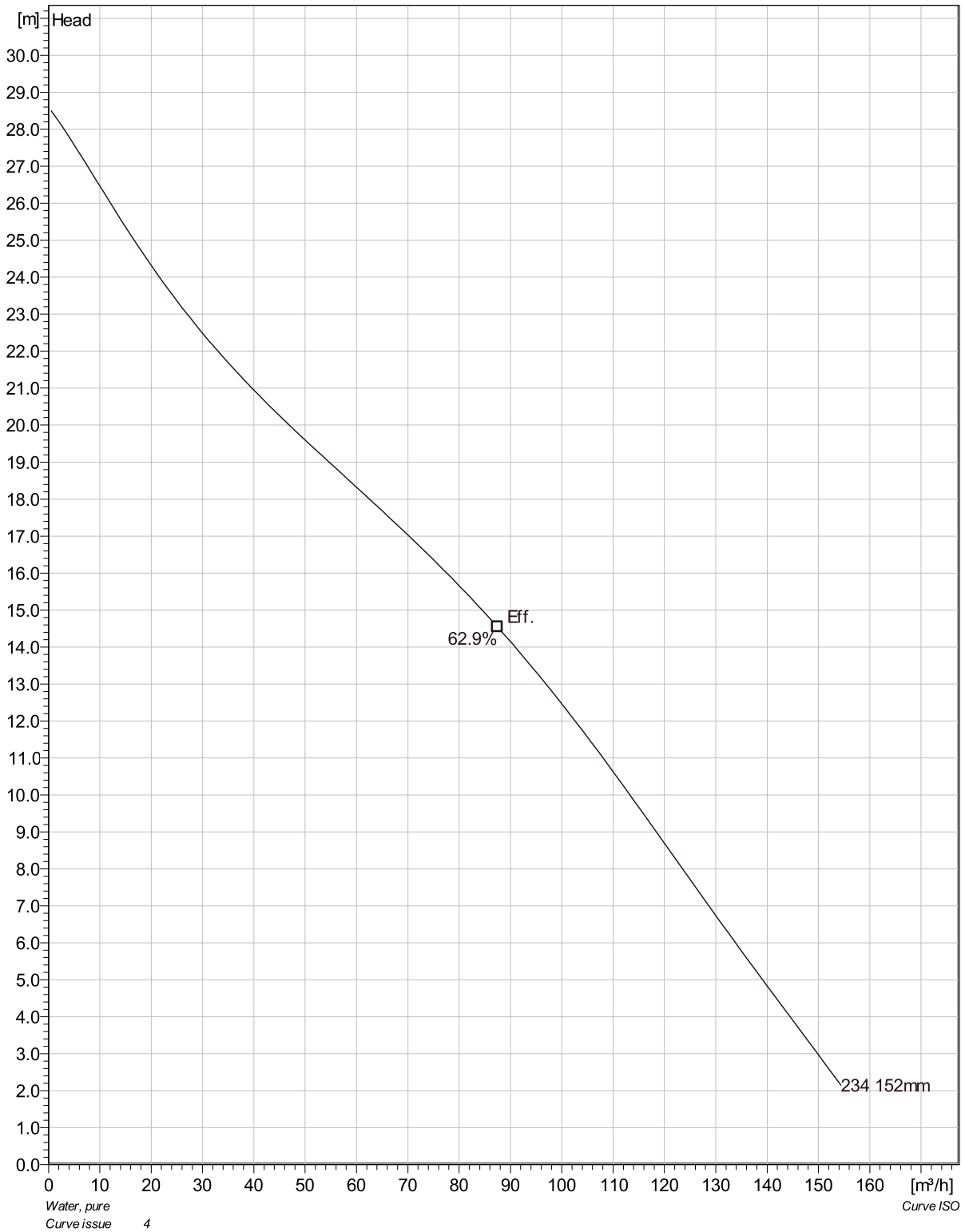

Project	Project ID	Created by	Created on	Last update
			9/21/2018	

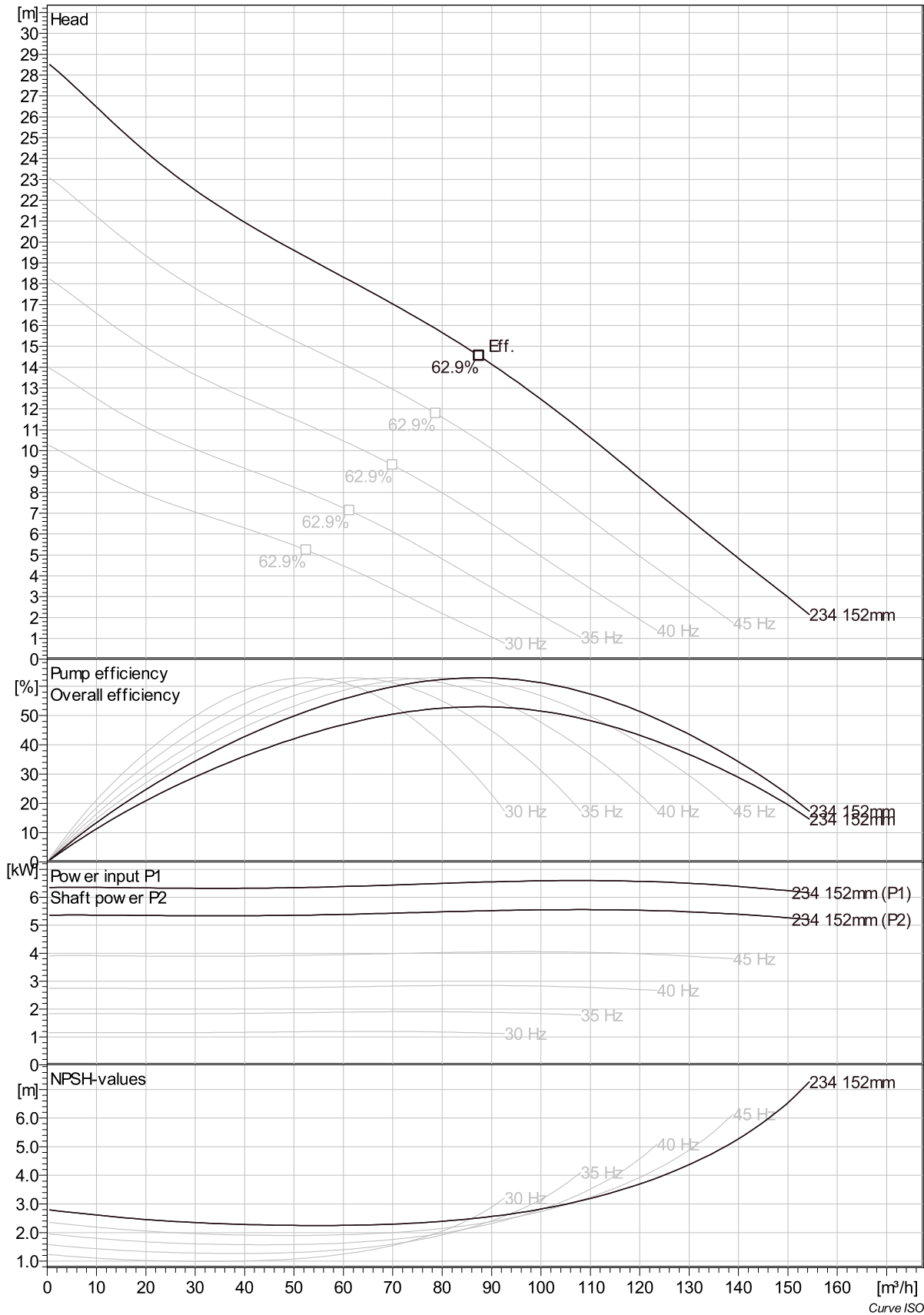

Project	Project ID	Created by	Created on	Last update
			9/21/2018	

KS 2640 MT 3~ 234 VFD Analysis

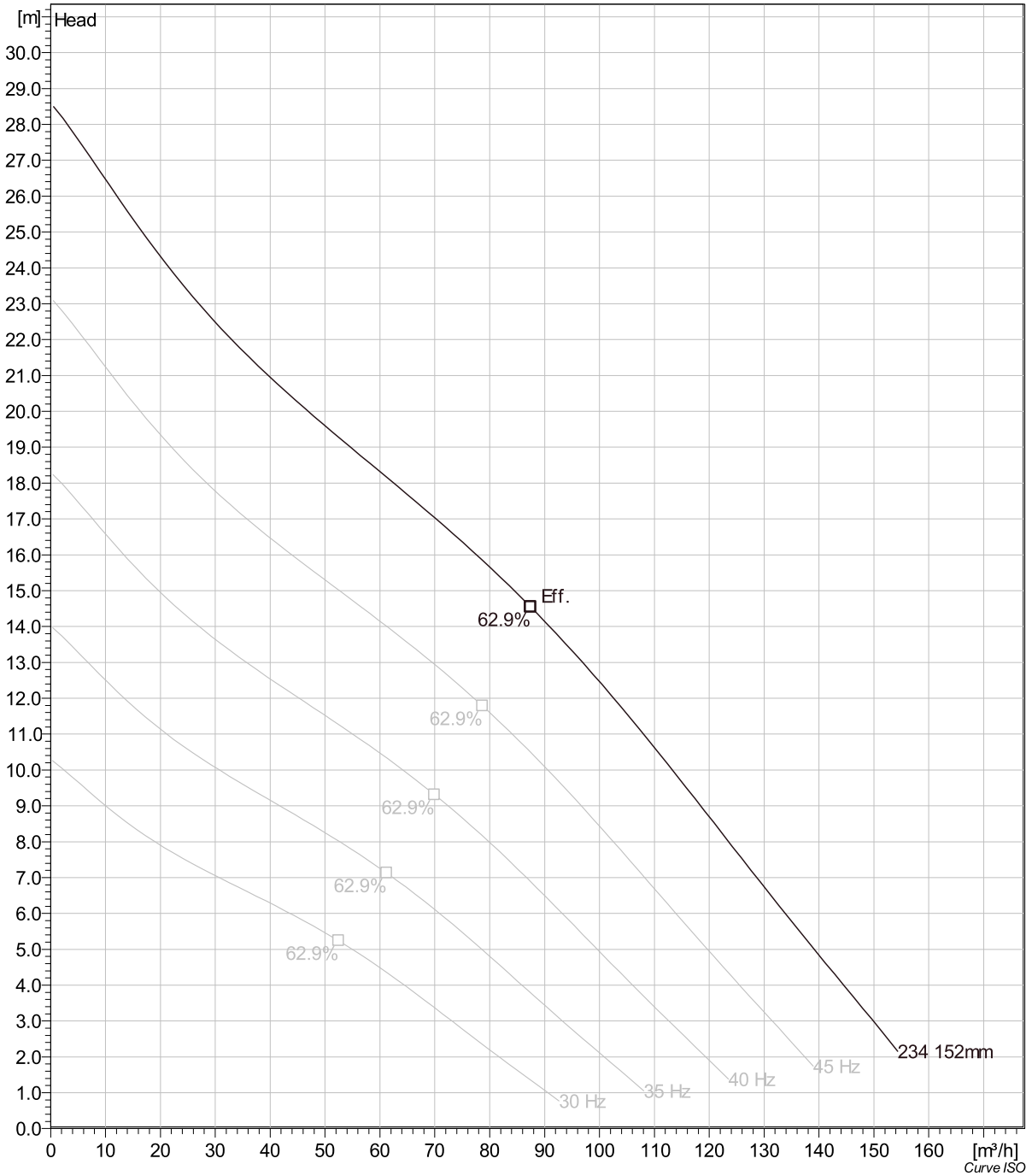

Project	Project ID	Created by	Created on	Last update
			9/21/2018	

KS 2640 MT 3~ 234 Dimensional drawing

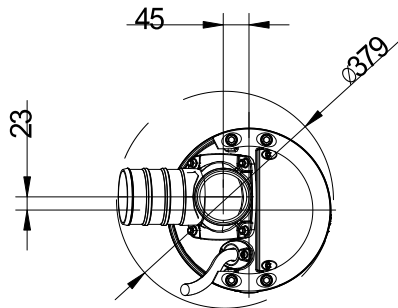
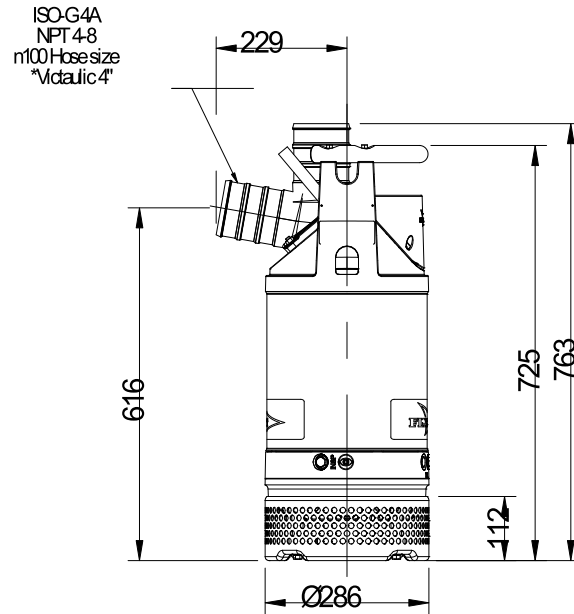

*Designed for "Victaulic Coupling
according to ANSI/AWWA C308-97

SCREEN OPENING n 10

Weight (kg)
Pump
50

BS,KS 2640.181 MT,HT

Project	Project ID	Created by	Created on 9/21/2018	Last update
---------	------------	------------	-------------------------	-------------